

Regenerate Construction Industry

with Digitized Management

5 Nov 2019



Project Management Tools – 3 Areas

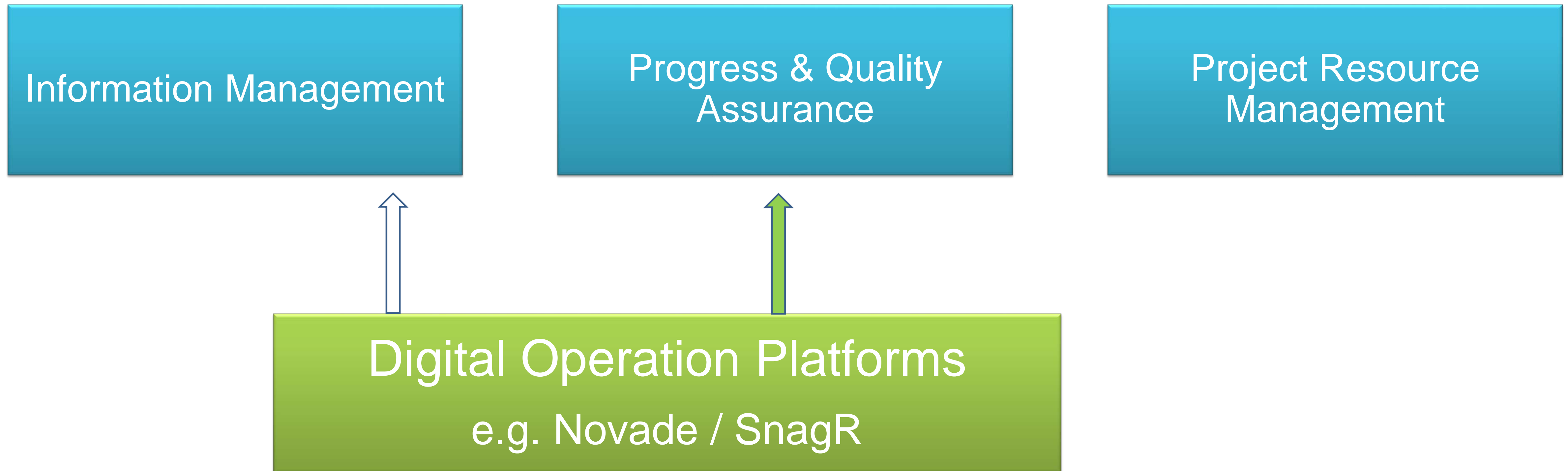

Construction is a Human-Centric Business



Can they (ever) get married?

A Long Journey of R&D Persistence

2016	Pilot testing (Handover defect inspection - SnagR)	
2018	<u>Switched solution to cover (Novade)</u> <ul style="list-style-type: none"> • Handover inspection • Safety & Environmental • Quality assurance • Factory floor management 	<u>Advantages</u> <ul style="list-style-type: none"> • Handle complex defect workflows • Flexible cost model • More platform neutral
Present	Rollout to all projects <ul style="list-style-type: none"> • HK Project Sites • Oversea Production Factories 	

Many Facets of Errors and Try

Quality

- Production quality control (Off-site)
- Construction quality assurance (On-site)
- Handover defect inspection

Safety & Environmental

- Non-conformance report (NCR)
- Permit to Work (PTW)
- Safety/Environmental forms (Example: 合資格人士委任書)

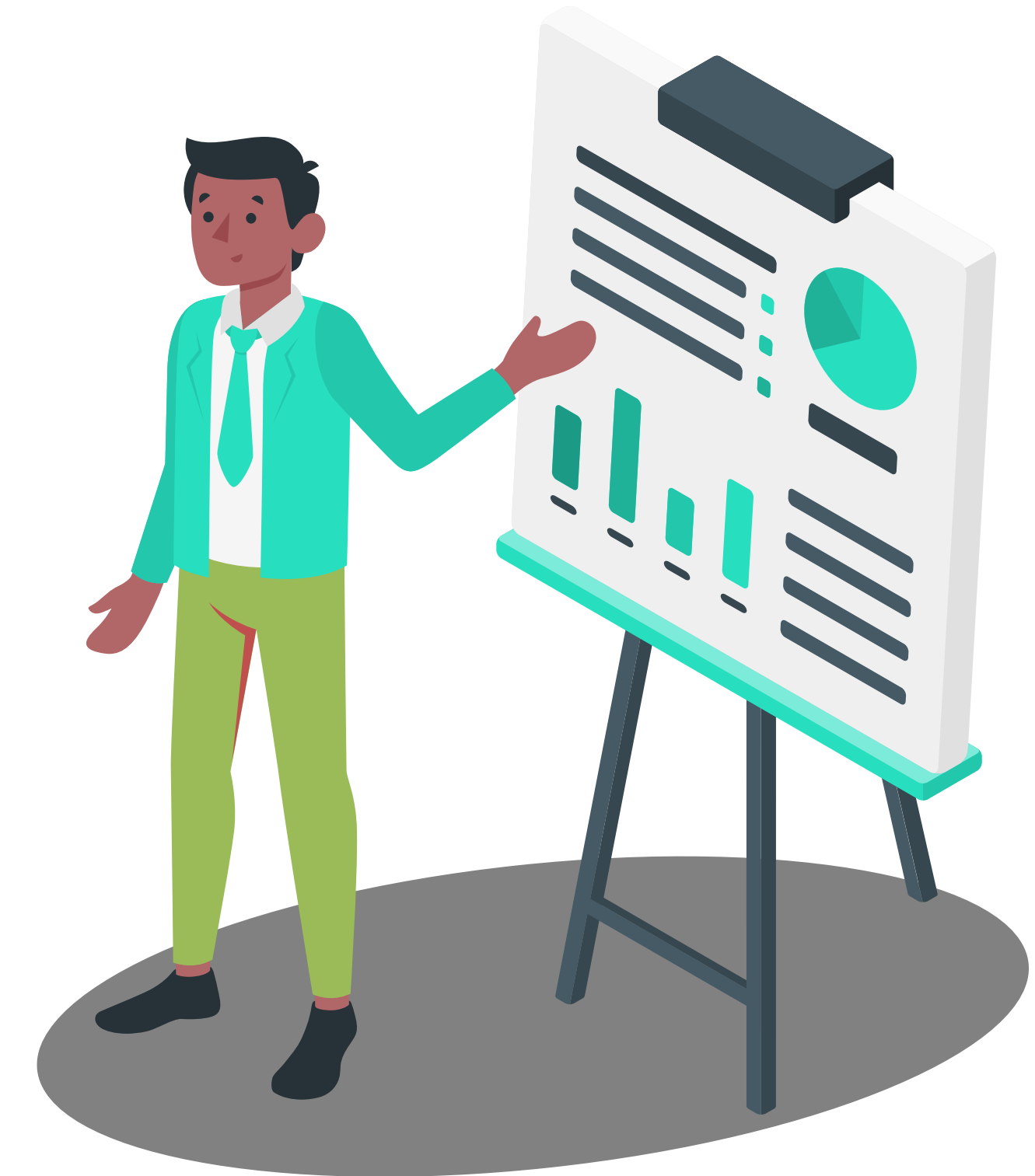

The Goodwill of a Digital Management Platform

Enhancement

- Streamline operations with digitalized workflow
- Proper and organized record keeping
- Progress tracking
- Paperless



A Digitized Workflow Concerns Human – Defect Tracking

Involved Parties

- Clerk of Works (CoW)
- Main Contractor (MC)
- Package Contractors (PCs)

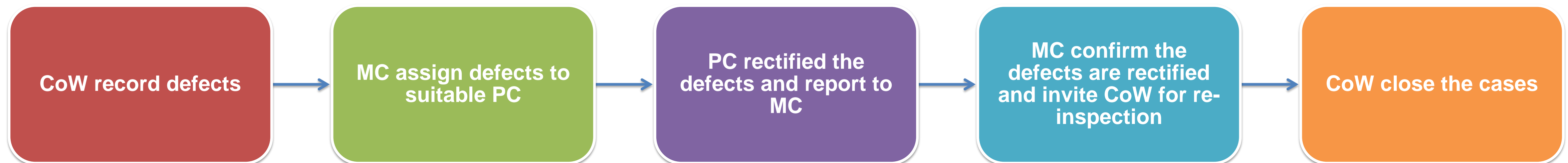

A Killer-App Solution, or any Better Around?

Clerk of Works

Management Contractor



Select the location

Select defect type

Record defect
(Photos, comment, Pin on floor plan)

MC to confirm the Defects and then assign PC to rectify

Management Contractor

Clerk of Work

PC rectified defect and inform MC to check

MC confirm the completion of rectification

MC inform CoW for re-inspection

CoW confirm and close the case

A Digitized Workflow Concerns Human – Work Permit

Involved Parties

- Frontline staff
- Package Contractors (PCs)

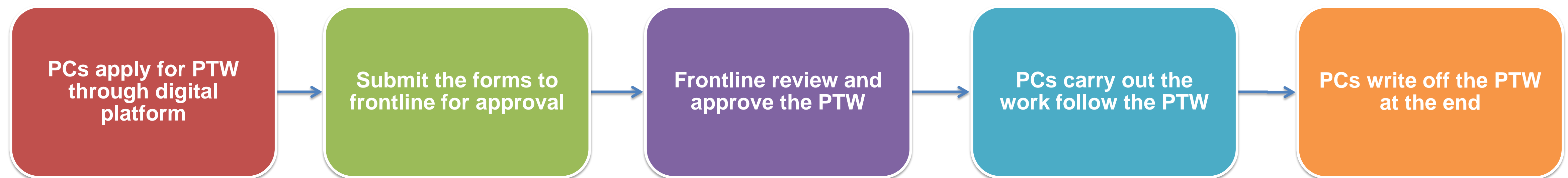

Fruit of a Mediated Marriage

Before

Project Management Tools – 3 Areas



For the Better Industry



Are we marriage-counseling ?





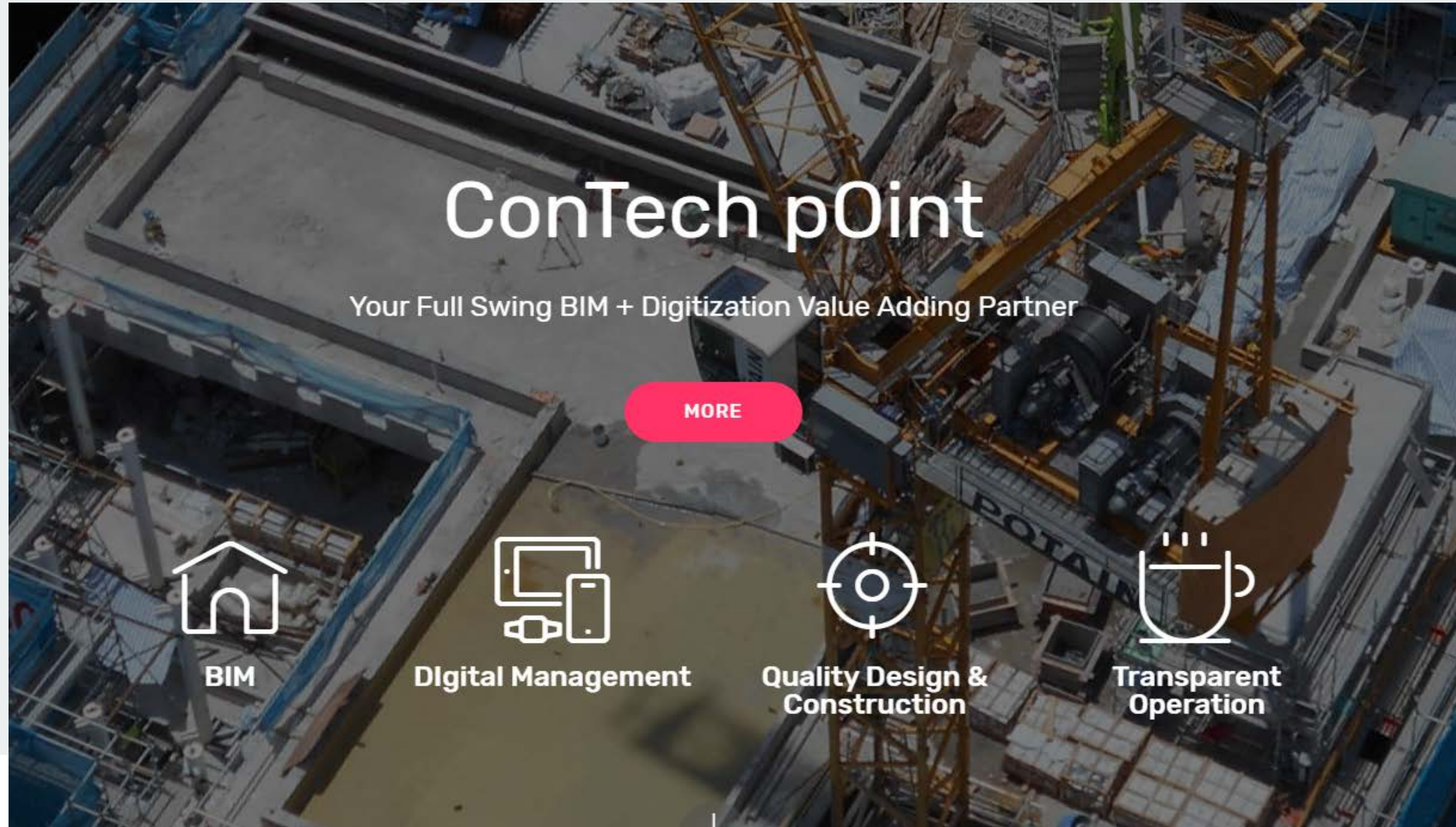

A Spin-off Partner for Construction Industry



ConTech p0int

Your Full Swing BIM + Digitization Value Adding Partner

MORE

- 
BIM
- 
Digital Management
- 
Quality Design & Construction
- 
Transparent Operation

Who We Are

We are a group of young professionals dedicated to better serve our built environment. A growing team of more than 100, we serve the construction and design sector for a decade with multidisciplinary and quality service as our core mindset. We are passionate in technology and have been applying digital methods to deliver design and construction throughout our practices.





Construction Information Anywhere

a cloud-based collaborative platform developed
by New World Construction for Project Information
and Workflow Management.



Patent

The CIA platform, first of its kind in Hong Kong, had been granted patent (no. HK1251889) by Patents Registry Intellectual Property Department under the Patents Ordinance (Chapter 514)

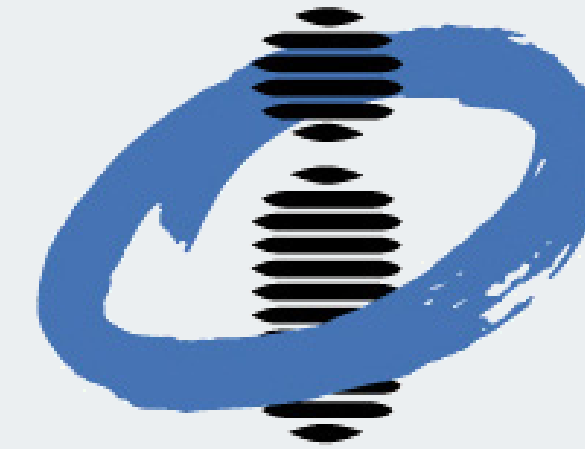

**香港特別行政區政府
知識產權署**

Intellectual Property Department
The Government of the Hong Kong
Special Administrative Region

CIA - as an Common Data Environment (CDE)

- Real-name system to login
- Control by user group permission access
- HTML5 and WebGL - Rich media capable

**Workflow
Submission**

**Document
Control System
(DCS)**

**Design
Information
Access**

1. Drawing
2. Animation
3. BIM
4. VVMU
5. 3D survey

Centralized database for project information storage and be shared among all project stakeholders with dedicated levels of security control.

Users



1,100+ Users



150+ Companies





Manage scattered information and their interactions

Generated from project life cycle, make sure project team is using the latest information to coordinate.

Store project information such as **Progress Report**, **BD Approved Plans**, **Coordinated/Construction/Shop Drawings**, **VVMU**, **3D Model**, **Walkthrough Video**, **360 Site Photo** and more.

DCS - Document Control System

Centralized database for project information storage and be shared among all project stakeholders with dedicated levels of security control.

NWCON ~ CIA

https://cia.nwconstruction.com.hk/index.aspx#Modules/ProjectList.aspx

Construction Information Anywhere

愛心建家園
在新世界我們都是工匠

New World Construction Co Ltd

Search anything...

Document Control System (DCS)

Active

Search

Daily Summary email will be sent at 5:45 P.M. every day

#	Project Code	Short Name	Project Title	Latest DocSet No	Total DocSet(s)	Total Documents	Total Drawings	Latest Updated	Status	
^ Corp: New World Construction Co Ltd										
1	00000A	Maintenance	Maintenance	100015	15	15			Active	Group Setting
2	12104	Fleur Pavilia	Kai Yuen Street (KYS)	100000	21251	21251		23-Feb-2018	Active	Group Setting
3	12105	Mount Pavilia	Clear Water Bay Road (CWBR), Mount Pavilia	100000	71079	71079		09-Mar-2018	Active	Group Setting
4	12106	NWC	New World Centre Redevelopment (NWC)	223066	197923	193224		05-Jul-2018	Active	Group Setting
5	12110	Park Hillcrest	Lot No. 2131 in D.D. 121, Tong Yan San Tsuen (TYST-2131A)	106638	8949	10037	2401	16-Jul-2018	Active	Group Setting
6	12114	PAM	Palace Mall Remodeling Project (PAM)	101043	17636	16969		08-Jan-2018	Active	Group Setting
7	13106	NWT	NWT	100121	2788	2802		22-Jun-2018	Active	Group Setting

Workflows Digital Transformation

Various Workflows (**RFI, TSF, SSF, DT...etc**) to allow users to submit, create, review, approve and reply with traceable history of each records.

All documents generated from these workflows will be automatically registered and maintained under the DCS system.



協盛建築有限公司
HIP SENG CONSTRUCTION CO LTD

REQUEST FOR INFORMATION

Project (Project Name)

Works (Project Works)

Contract No. (Contract No.)

Ref. No. (Project No.)/MC/RFI/(AR/SE/BS)-00XX (Rev. 0)

Date **1 March 2017**

To / Attn. **Ronald Lu & Partners (Hong Kong) Ltd.**
Mr. Patrick Chui / Mr. Peter Kwan

Subject **Architectural Aspect – (14105D-DCS)**

Anticipated date of response **15 March 2017**

Query

Related Specification

Related Drawing

Affected Activity

Form RFI

Received by SE / BS / LA /

Received by (Architects Firm)

cc	w/e	
Client	<input checked="" type="checkbox"/>	LV – Mr. Terence Wong / Ms. Candy Li
Client	<input checked="" type="checkbox"/>	MTFC – Mr. Lawrence Yam / Mr. Brian Li
Client	<input checked="" type="checkbox"/>	MTFC – Mr. Eric Chan
OPD	<input checked="" type="checkbox"/>	MTFC – Mr. Jasmine Ho
SE	<input checked="" type="checkbox"/>	Sam-J, Tom Chui, P. Joseph Lee
BS	<input checked="" type="checkbox"/>	WSP – Mr. K. F. Tsui
OS	<input checked="" type="checkbox"/>	IAS – Mr. Ronnie Tang
AXXA	<input checked="" type="checkbox"/>	Ms. Camille Lam
M/A	<input checked="" type="checkbox"/>	Ms. Louisa Tse
Site Rep.	<input checked="" type="checkbox"/>	MTFC – Mr. T. C. Wong / Mr. P. T. Wong
RE	<input checked="" type="checkbox"/>	Sam – Mr. Gordon Tang
RSM / RSD	<input checked="" type="checkbox"/>	LV – Mr. Sammy Siu / Mr. Wallace Mok
Site Office	<input checked="" type="checkbox"/>	

(Project PIC Name) (His/Her Position)

(Signature)

For and on behalf of

Hip Seng Construction Company Limited

☒ w/e

RESPONSE TO RFI

Date

Response

Replied by SE / Date

Replied by BS / Date

Replied by / Date

cc	w/e	
Client	<input checked="" type="checkbox"/>	LV – Mr. Terence Wong / Ms. Candy Li
Client	<input checked="" type="checkbox"/>	MTFC – Mr. Lawrence Yam / Mr. Brian Li
Client	<input checked="" type="checkbox"/>	MTFC – Mr. Eric Chan
OPD	<input checked="" type="checkbox"/>	MTFC – Mr. Jasmine Ho
SE	<input checked="" type="checkbox"/>	Sam-J, Tom Chui, P. Joseph Lee
BS	<input checked="" type="checkbox"/>	WSP – Mr. K. F. Tsui
OS	<input checked="" type="checkbox"/>	IAS – Mr. Ronnie Tang
AXXA	<input checked="" type="checkbox"/>	Ms. Camille Lam
M/A	<input checked="" type="checkbox"/>	Ms. Louisa Tse
Site Rep.	<input checked="" type="checkbox"/>	MTFC – Mr. T. C. Wong / Mr. P. T. Wong
RE	<input checked="" type="checkbox"/>	Sam – Mr. Gordon Tang
RSM	<input checked="" type="checkbox"/>	LV – Mr. Sammy Siu / Mr. Wallace Mok
Site Office	<input checked="" type="checkbox"/>	

(LOGO of the Arch.)

For and on behalf of

(Name of the Architects Firm)

☐ w/e

2014 Ronald Lu & Partners (Hong Kong) Ltd. All Rights Reserved

Original Workflow Form

Workflows Digital Transformation



Various Workflows (**RFI, TSF, SSF, DT...**etc) to allow users to submit, create, review, approve and reply with traceable history of each records.

All documents generated from these workflows will be automatically registered and maintained under the DCS system.

Request For Information (RFI)

Project	14105 Tai Wai Station (TAW)	Status	Draft
Contract No	14105B TAWMOL	Discipline	Architectural
Works	MOL Viaduct Enclosure, New Plant Rooms and Modification of S-23 Nominated Sub-Contract Works	Zone	
Grid		Location	
To / Attn	Ronald Lu & Partners (Hong Kong) Ltd - Mr. Patrick Chui / Mr. Peter Kwan	CC List :	
Subject		CC W/E	
Description / Query		Client	<input type="checkbox"/> LVL - Mr. Terence Wong / Mr. Angus Yip / Ms. Candy Li
Related Specification		Client	<input type="checkbox"/> LVL - Mr. Kenneth Fan / Mr. C. Y. Ho
Drawing Reference		Client	<input type="checkbox"/> LVL - Mr. Gavin Tang / Mr. Sam Hung
Affected Activity		Client	<input type="checkbox"/> MTRC - Mr. Lawrence Yam / Ms. Sonia Choi
Purpose		Client	<input type="checkbox"/> MTRC - Mr. Brian Li / Mr. Eric Chan
Reviewer		Client	<input type="checkbox"/> MTRC - Mr. William Chan / Mr. Homond Leung
Approver		OP/D	<input type="checkbox"/> MTRC - Ms. Jasmine Ho
		SE	<input type="checkbox"/> Arup - Ir. Tong Choi / Ir. Joseph Law
		BS	<input type="checkbox"/> WSP - Mr. K. F. Tsui (Podium)
		BS	<input type="checkbox"/> WSP - Mr. Eric Lo (Residential)
		OS	<input type="checkbox"/> Arcadis - Mr. Ronnie Tong
		LA	<input type="checkbox"/> AXXA - Ms. Camay Lam
		Site Rep.	<input type="checkbox"/> MTRC - Mr. T. C. Wong / Mr. P. T. Wong
		COW	<input type="checkbox"/> LVL - Mr. Stanley Ng
		RE	<input type="checkbox"/> Arup - Mr. Tony Khoo
		RBSE	<input type="checkbox"/> WSP - Mr. T. H. Wong / Mr. K. P. Ng / Mr. Eric Chau
		RSM / RSO	<input type="checkbox"/> LVL - Mr. Sammy Siu / Mr. Wallace Mok / Mr. Eric Ng
		ID	<input type="checkbox"/> BTR - Mr. Terence Or / Ms. Mandy Cheng
		BEAM Plus	<input type="checkbox"/> Arup (BEAM) - Mr. Ricky Li / Mr. Kelvin Chow
		Site Office	<input type="checkbox"/>

HIP SENG CONSTRUCTION CO LTD																																																				
<h2 style="margin: 0;">SHOP DRAWING SUBMISSION FORM</h2>																																																				
Project	14105D TAWMC - Proposed Property Development on S.T.T.L. No. 520, Tai Wai Station, Tai Wai, Shatin, N.T. Sub-Structure and Superstructure Main Contract Works																																																			
Works	14105D TAWMC																																																			
Contract No.	14164NT/MC/SSF/AR-0172 (Rev. 0)																																																			
Ref. No.	15 April 2019																																																			
Date	Ronald Lu & Partners (Hong Kong) Ltd																																																			
To / Attn	Mr. Patrick Chui / Mr. Peter Kwan																																																			
Subject	Architectural Aspect - Shop Drawing Submission of Typical Water Proofing Detail to Movement Joint System Type 7 at Podium Zone A,B,C 14105D-DCS122944																																																			
Anticipated date of response 29 April 2019																																																				
We certify that the submission has been checked and is in full compliance with the Specification & Contract Documents, unless otherwise stated in the remarks.																																																				
<p>This is an automatically generated QR Code for the record of signature by the undersigned of this document. Basic details of this document and the link to read the full details can be accessed by scanning this code.</p>	<div style="float: right; text-align: right;"> Form RLP/SSF Received by SE / BS / LA / Received by RLP </div> <div style="clear: both;"></div>																																																			
Cesar Tong Ka Wai (Senior Project Manager) CT/JHS/LKW For and on behalf of Hip Seng Construction Co Ltd																																																				
<table border="1" style="width: 100%; border-collapse: collapse;"> <thead> <tr> <th style="width: 20%;">Drawing No.</th> <th style="width: 10%;">Rev.</th> <th>Description</th> </tr> </thead> <tbody> <tr> <td>WWY-TWS(MJ)-SK001</td> <td style="text-align: center;">1</td> <td>water proofing detail of interfacing to movement joint (floor or planter curb)</td> </tr> <tr> <td>WWY-TWS(MJ)-SK002</td> <td style="text-align: center;">1</td> <td>water proofing detail at L6 and ball court at L6R</td> </tr> </tbody> </table>	Drawing No.	Rev.	Description	WWY-TWS(MJ)-SK001	1	water proofing detail of interfacing to movement joint (floor or planter curb)	WWY-TWS(MJ)-SK002	1	water proofing detail at L6 and ball court at L6R	<table border="1" style="width: 100%; border-collapse: collapse;"> <thead> <tr> <th style="width: 60%;">Client</th> <th style="width: 40%;">CC/WSE</th> </tr> </thead> <tbody> <tr><td>Client</td><td>[X] I LVL – Mr. Terence Wong / Mr. Angus Yip / Ms. Candy Li</td></tr> <tr><td>Client</td><td>[] I LVL – Mr. Kenneth Fan / Mr. C.Y. Ho</td></tr> <tr><td>Client</td><td>[] I LVL – Mr. Gavin Tang / Mr. Sam Hung</td></tr> <tr><td>Client</td><td>[X] I MTRC – Mr. Lawrence Yam / Ms. Sonia Choi</td></tr> <tr><td>Client</td><td>[] I MTRC – Mr. Brian Li / Mr. Eric Chan</td></tr> <tr><td>Client</td><td>[] I MTRC – Mr. William Chan / Mr. Homend Leung</td></tr> <tr><td>Client</td><td>[] I MTRC – Ms. Jasmine Ho</td></tr> <tr><td>SE</td><td>[X] I Aug. – Ir. Tong Chee / R. Joseph Law</td></tr> <tr><td>BS</td><td>[] I WSP – Mr. K.F. Tsui (Podium)</td></tr> <tr><td>BS</td><td>[] I WSP – Mr. Eric Lo (Residential)</td></tr> <tr><td>QS</td><td>[] I Arcadis – Mr. Ronnie Tong</td></tr> <tr><td>LA</td><td>[] I AXAA – Ms. Cammy Lam</td></tr> <tr><td>Site Rep.</td><td>[X] I MTRC – Mr. T.C. Wong / Mr. P.T. Wong</td></tr> <tr><td>COW</td><td>[X] I LVL – Mr. Stanley Ng</td></tr> <tr><td>RE</td><td>[X] I Aug. – Mr. Tony Xieo</td></tr> <tr><td>RBSE</td><td>[] I WSP – Mr. T.H. Wong / Mr. K.P. Ng / Mr. Eric Chau</td></tr> <tr><td>RSB / RSO</td><td>[] I LVL – Mr. Sammy Siu / Mr. Wallace Mok / Mr. Eric Ng</td></tr> <tr><td>ID</td><td>[] I BTR – Mr. Terence Or / Ms. Mandy Cheng</td></tr> <tr><td>BEAM Plus</td><td>[] I Aug.(BEAM) – Mr. Ricky Li / Mr. Kelvin Chow</td></tr> <tr><td>Site Office</td><td>[] I</td></tr> </tbody> </table>	Client	CC/WSE	Client	[X] I LVL – Mr. Terence Wong / Mr. Angus Yip / Ms. Candy Li	Client	[] I LVL – Mr. Kenneth Fan / Mr. C.Y. Ho	Client	[] I LVL – Mr. Gavin Tang / Mr. Sam Hung	Client	[X] I MTRC – Mr. Lawrence Yam / Ms. Sonia Choi	Client	[] I MTRC – Mr. Brian Li / Mr. Eric Chan	Client	[] I MTRC – Mr. William Chan / Mr. Homend Leung	Client	[] I MTRC – Ms. Jasmine Ho	SE	[X] I Aug. – Ir. Tong Chee / R. Joseph Law	BS	[] I WSP – Mr. K.F. Tsui (Podium)	BS	[] I WSP – Mr. Eric Lo (Residential)	QS	[] I Arcadis – Mr. Ronnie Tong	LA	[] I AXAA – Ms. Cammy Lam	Site Rep.	[X] I MTRC – Mr. T.C. Wong / Mr. P.T. Wong	COW	[X] I LVL – Mr. Stanley Ng	RE	[X] I Aug. – Mr. Tony Xieo	RBSE	[] I WSP – Mr. T.H. Wong / Mr. K.P. Ng / Mr. Eric Chau	RSB / RSO	[] I LVL – Mr. Sammy Siu / Mr. Wallace Mok / Mr. Eric Ng	ID	[] I BTR – Mr. Terence Or / Ms. Mandy Cheng	BEAM Plus	[] I Aug.(BEAM) – Mr. Ricky Li / Mr. Kelvin Chow	Site Office	[] I
Drawing No.	Rev.	Description																																																		
WWY-TWS(MJ)-SK001	1	water proofing detail of interfacing to movement joint (floor or planter curb)																																																		
WWY-TWS(MJ)-SK002	1	water proofing detail at L6 and ball court at L6R																																																		
Client	CC/WSE																																																			
Client	[X] I LVL – Mr. Terence Wong / Mr. Angus Yip / Ms. Candy Li																																																			
Client	[] I LVL – Mr. Kenneth Fan / Mr. C.Y. Ho																																																			
Client	[] I LVL – Mr. Gavin Tang / Mr. Sam Hung																																																			
Client	[X] I MTRC – Mr. Lawrence Yam / Ms. Sonia Choi																																																			
Client	[] I MTRC – Mr. Brian Li / Mr. Eric Chan																																																			
Client	[] I MTRC – Mr. William Chan / Mr. Homend Leung																																																			
Client	[] I MTRC – Ms. Jasmine Ho																																																			
SE	[X] I Aug. – Ir. Tong Chee / R. Joseph Law																																																			
BS	[] I WSP – Mr. K.F. Tsui (Podium)																																																			
BS	[] I WSP – Mr. Eric Lo (Residential)																																																			
QS	[] I Arcadis – Mr. Ronnie Tong																																																			
LA	[] I AXAA – Ms. Cammy Lam																																																			
Site Rep.	[X] I MTRC – Mr. T.C. Wong / Mr. P.T. Wong																																																			
COW	[X] I LVL – Mr. Stanley Ng																																																			
RE	[X] I Aug. – Mr. Tony Xieo																																																			
RBSE	[] I WSP – Mr. T.H. Wong / Mr. K.P. Ng / Mr. Eric Chau																																																			
RSB / RSO	[] I LVL – Mr. Sammy Siu / Mr. Wallace Mok / Mr. Eric Ng																																																			
ID	[] I BTR – Mr. Terence Or / Ms. Mandy Cheng																																																			
BEAM Plus	[] I Aug.(BEAM) – Mr. Ricky Li / Mr. Kelvin Chow																																																			
Site Office	[] I																																																			
<table border="1" style="width: 100%; border-collapse: collapse;"> <thead> <tr> <th style="width: 60%;">Remarks (To list deviations, if any)</th> <th style="width: 40%;">Review Status / Comment</th> </tr> </thead> <tbody> <tr> <td>* NA</td> <td></td> </tr> </tbody> </table>		Remarks (To list deviations, if any)	Review Status / Comment	* NA																																																
Remarks (To list deviations, if any)	Review Status / Comment																																																			
* NA																																																				
RESPONSE TO SHOP DRAWING SUBMISSION																																																				
Date Comments	<table border="1" style="width: 100%; border-collapse: collapse;"> <thead> <tr> <th style="width: 60%;">Client</th> <th style="width: 40%;">CC/WSE</th> </tr> </thead> <tbody> <tr><td>Client</td><td>[] I LVL – Mr. Terence Wong / Mr. Angus Yip / Ms. Candy Li</td></tr> <tr><td>Client</td><td>[] I LVL – Mr. Kenneth Fan / Mr. C.Y. Ho</td></tr> <tr><td>Client</td><td>[] I LVL – Mr. Gavin Tang / Mr. Sam Hung</td></tr> <tr><td>Client</td><td>[] I MTRC – Mr. Lawrence Yam / Ms. Sonia Choi</td></tr> <tr><td>Client</td><td>[] I MTRC – Mr. Brian Li / Mr. Eric Chan</td></tr> <tr><td>Client</td><td>[] I MTRC – Mr. William Chan / Mr. Homend Leung</td></tr> <tr><td>Client</td><td>[] I MTRC – Ms. Jasmine Ho</td></tr> <tr><td>SE</td><td>[X] I Aug. – Ir. Tong Chee / R. Joseph Law</td></tr> <tr><td>BS</td><td>[] I WSP – Mr. K.F. Tsui (Podium)</td></tr> <tr><td>BS</td><td>[] I WSP – Mr. Eric Lo (Residential)</td></tr> <tr><td>QS</td><td>[] I Arcadis – Mr. Ronnie Tong</td></tr> <tr><td>LA</td><td>[] I AXAA – Ms. Cammy Lam</td></tr> <tr><td>Site Rep.</td><td>[X] I MTRC – Mr. T.C. Wong / Mr. P.T. Wong</td></tr> <tr><td>COW</td><td>[X] I LVL – Mr. Stanley Ng</td></tr> <tr><td>RE</td><td>[X] I Aug. – Mr. Tony Xieo</td></tr> <tr><td>RBSE</td><td>[] I WSP – Mr. T.H. Wong / Mr. K.P. Ng / Mr. Eric Chau</td></tr> <tr><td>RSB / RSO</td><td>[] I LVL – Mr. Sammy Siu / Mr. Wallace Mok / Mr. Eric Ng</td></tr> <tr><td>ID</td><td>[] I BTR – Mr. Terence Or / Ms. Mandy Cheng</td></tr> <tr><td>BEAM Plus</td><td>[] I Aug.(BEAM) – Mr. Ricky Li / Mr. Kelvin Chow</td></tr> <tr><td>Site Office</td><td>[] I</td></tr> </tbody> </table>	Client	CC/WSE	Client	[] I LVL – Mr. Terence Wong / Mr. Angus Yip / Ms. Candy Li	Client	[] I LVL – Mr. Kenneth Fan / Mr. C.Y. Ho	Client	[] I LVL – Mr. Gavin Tang / Mr. Sam Hung	Client	[] I MTRC – Mr. Lawrence Yam / Ms. Sonia Choi	Client	[] I MTRC – Mr. Brian Li / Mr. Eric Chan	Client	[] I MTRC – Mr. William Chan / Mr. Homend Leung	Client	[] I MTRC – Ms. Jasmine Ho	SE	[X] I Aug. – Ir. Tong Chee / R. Joseph Law	BS	[] I WSP – Mr. K.F. Tsui (Podium)	BS	[] I WSP – Mr. Eric Lo (Residential)	QS	[] I Arcadis – Mr. Ronnie Tong	LA	[] I AXAA – Ms. Cammy Lam	Site Rep.	[X] I MTRC – Mr. T.C. Wong / Mr. P.T. Wong	COW	[X] I LVL – Mr. Stanley Ng	RE	[X] I Aug. – Mr. Tony Xieo	RBSE	[] I WSP – Mr. T.H. Wong / Mr. K.P. Ng / Mr. Eric Chau	RSB / RSO	[] I LVL – Mr. Sammy Siu / Mr. Wallace Mok / Mr. Eric Ng	ID	[] I BTR – Mr. Terence Or / Ms. Mandy Cheng	BEAM Plus	[] I Aug.(BEAM) – Mr. Ricky Li / Mr. Kelvin Chow	Site Office	[] I									
Client	CC/WSE																																																			
Client	[] I LVL – Mr. Terence Wong / Mr. Angus Yip / Ms. Candy Li																																																			
Client	[] I LVL – Mr. Kenneth Fan / Mr. C.Y. Ho																																																			
Client	[] I LVL – Mr. Gavin Tang / Mr. Sam Hung																																																			
Client	[] I MTRC – Mr. Lawrence Yam / Ms. Sonia Choi																																																			
Client	[] I MTRC – Mr. Brian Li / Mr. Eric Chan																																																			
Client	[] I MTRC – Mr. William Chan / Mr. Homend Leung																																																			
Client	[] I MTRC – Ms. Jasmine Ho																																																			
SE	[X] I Aug. – Ir. Tong Chee / R. Joseph Law																																																			
BS	[] I WSP – Mr. K.F. Tsui (Podium)																																																			
BS	[] I WSP – Mr. Eric Lo (Residential)																																																			
QS	[] I Arcadis – Mr. Ronnie Tong																																																			
LA	[] I AXAA – Ms. Cammy Lam																																																			
Site Rep.	[X] I MTRC – Mr. T.C. Wong / Mr. P.T. Wong																																																			
COW	[X] I LVL – Mr. Stanley Ng																																																			
RE	[X] I Aug. – Mr. Tony Xieo																																																			
RBSE	[] I WSP – Mr. T.H. Wong / Mr. K.P. Ng / Mr. Eric Chau																																																			
RSB / RSO	[] I LVL – Mr. Sammy Siu / Mr. Wallace Mok / Mr. Eric Ng																																																			
ID	[] I BTR – Mr. Terence Or / Ms. Mandy Cheng																																																			
BEAM Plus	[] I Aug.(BEAM) – Mr. Ricky Li / Mr. Kelvin Chow																																																			
Site Office	[] I																																																			
<table border="1" style="width: 100%; border-collapse: collapse;"> <thead> <tr> <th style="width: 60%;">Reviewed By</th> <th style="width: 40%;">Date</th> </tr> </thead> <tbody> <tr> <td>Replied by SE / Date</td> <td></td> </tr> <tr> <td>Replied by BS / Date</td> <td></td> </tr> <tr> <td>Replied by / Date</td> <td></td> </tr> </tbody> </table>		Reviewed By	Date	Replied by SE / Date		Replied by BS / Date		Replied by / Date																																												
Reviewed By	Date																																																			
Replied by SE / Date																																																				
Replied by BS / Date																																																				
Replied by / Date																																																				
<div style="display: flex; align-items: center;"> <div> RONALD LU & PARTNERS For and on behalf of Ronald Lu & Partners (Hong Kong) Ltd </div> </div>																																																				
No review is made of detail dimensions/tolerances. The submission is reviewed for general compliance with the design intent only. Any comments or amendments required shall not be deemed to be variation. The review does not release the Contractor from his responsibilities to comply with contract requirements. For resubmission, the Contractor has to highlight or cloud those revision areas in the shop drawing for review.																																																				
Legend: A (No objection) C (Amendment & resubmission required) B (No objection, subject to comments as noted) D (Rejected & resubmission required)																																																				
[] w/e																																																				

2004 Ronald Lu & Partners (Hong Kong) Ltd. All Rights Reserved
 Page 1 of 1

Transformed Digitalized Workflow eForm

eSignature

CIA e-Signature is a QR Code on the PDF, allow user to scan the QR Code to visit e-Signature Verification.

The CIA e-Signature Verification shows:

1. The submission form is generated by CIA and official approval / reply by CIA User
2. Document No. and Approved / Replied Date
3. Link to submission form to view more detail

協盛建築有限公司
HIP SENG CONSTRUCTION CO. LTD.

SHOP DRAWING SUBMISSION FORM

Project: **14105D TAWMC - Proposed Property Development on S.T.T.L.**
No. 520, Tai Wai Station, Tai Wai, Shatin, N.T.
Works: Sub-Structure and Superstructure Main Contract Works
Contract No.: 14105D TAWMC
Ref. No.: 14164NT/MC/SSF/AR-0172 (Rev. 0)
Date: 15 April 2019
To / Attn: Ronald Lu & Partners (Hong Kong) Ltd
Mr. Patrick Chui / Mr. Peter Kwan

Subject: Architectural Aspect - Shop Drawing Submission of Typical Water Proofing Detail to Movement Joint System Type 7 at Podium Zone A,B,C
14105D-DCS122944

Anticipated date of response: 29 April 2019

We certify that the submission has been checked and is in full compliance with the Specification & Contract Documents, unless otherwise stated in the remarks.

Caesar Tong Ka Wai (Senior Project Manager) CT/HSL/KKW
For and on behalf of
Hip Seng Construction Co Ltd

Drawing No. WWY-TWS(MJ)-SK001
Rev. 1
Description water proofing detail of interfacing to movement joint (floor or planter curb)

Drawing No. WWY-TWS(MJ)-SK002
Rev. 1
Description water proofing detail at L6 and ball court at L6R

Remarks (To list deviations, if any)
+ NA

RESPONSE TO SHOP DRAWING SUBMISSION
Date: _____
Comments: _____

RONALD LU & PARTNERS
For and on behalf of
Ronald Lu & Partners (Hong Kong) Ltd

No review is made of detail dimensions/quantities.
The submission is reviewed for general compliance with the design intent only.
Any comments or amendments required shall not be deemed to be variation.
The review does not release the Contractor from his responsibilities to comply with contract requirements.
For resubmission, the Contractor has to highlight or cloud those revision areas in the shop drawing for review.

Legend: A (No objection) C (Amendment & resubmission required)
B (No objection, subject to comments as noted) D (Rejected & resubmission required)

Client: [] LVL - Mr. Terence Wong / Mr. Angus Yip / Ms. Candy Li
Client: [] LVL - Mr. Kenneth Fan / Mr. C. Y. Ho
Client: [] LVL - Mr. Gavin Tang / Mr. Sam Hung
Client: [] MTBC - Mr. Lawrence Yam / Ms. Sonia Choi
Client: [] MTBC - Mr. Brian Li / Mr. Eric Chan
Client: [] MTBC - Mr. William Chan / Mr. Homard Leung
Client: [] MTBC - Ms. Jasmine Ho
OPD: [] Anup - Mr. Tony Khoo
SE: [] Anup - Mr. Tony Khoo
BS: [] WSP - Mr. K. F. Tsui (Podium)
BS: [] WSP - Mr. Eric Lo (Residential)
QS: [] Arcadis - Mr. Bonnie Tong
LA: [] AXXA - Ms. Camay Lam
Site Rep: [] MTBC - Mr. T. C. Wong / Mr. P. T. Wong
COW: [] LVL - Mr. Stanley Ng
RE: [] Anup - Mr. Stanley Ng
RSE: [] WSP - Mr. T. H. Wong / Mr. K. P. Ng / Mr. Eric Chau
RSM / RSO: [] LVL - Mr. Sammy Siu / Mr. Wallace Mok / Mr. Eric Ng
ID: [] BTR - Mr. Terence Dr. / Ms. Mandy Cheng
BEAM Plus: [] Anup (BEAM) - Mr. Ricky Li / Mr. Kelvin Chow
Site Office: []

2004 Ronald Lu & Partners (Hong Kong) Ltd. All Rights Reserved
Page 1 of 1

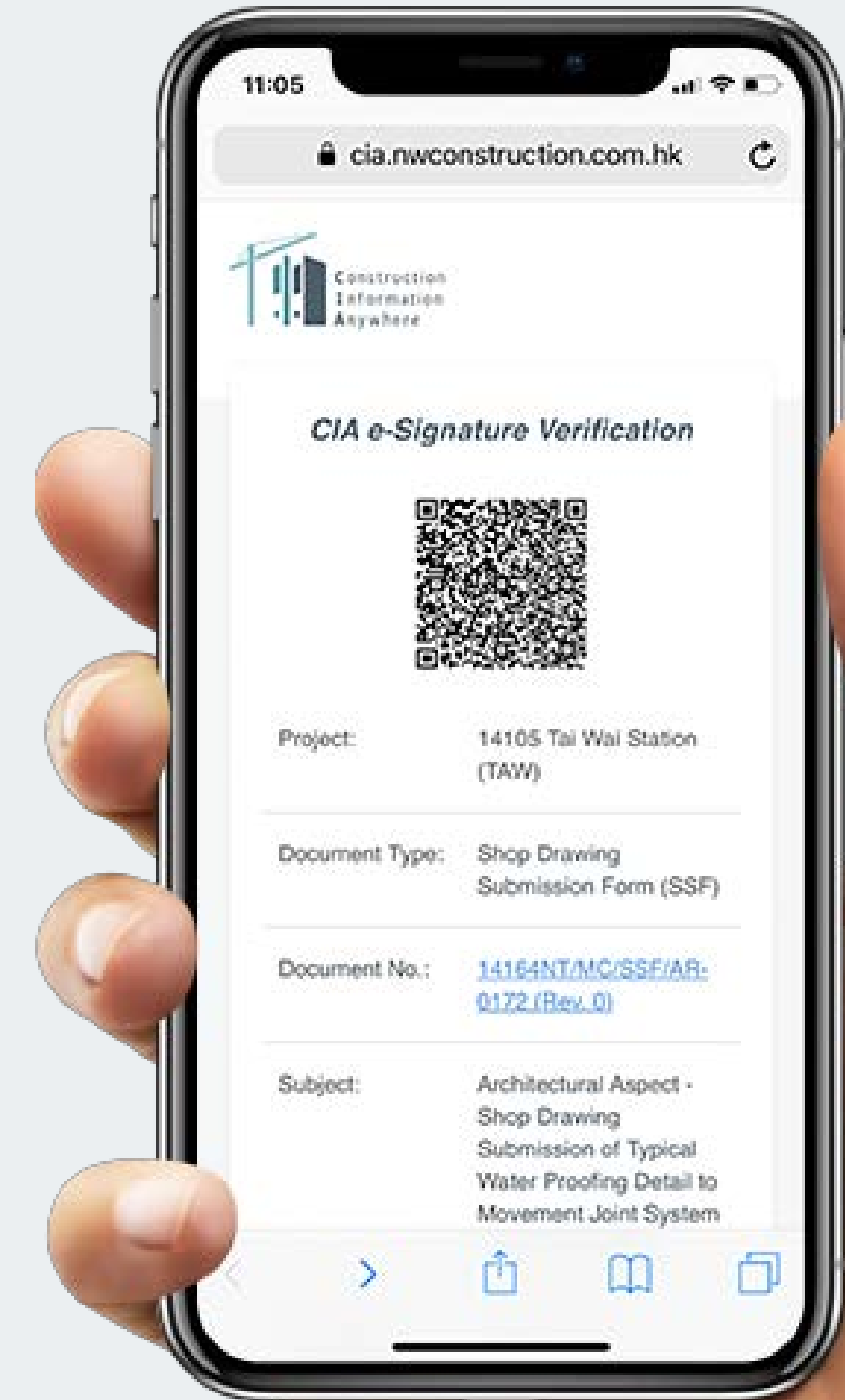

Design Drawings & 360 Site Context Photos

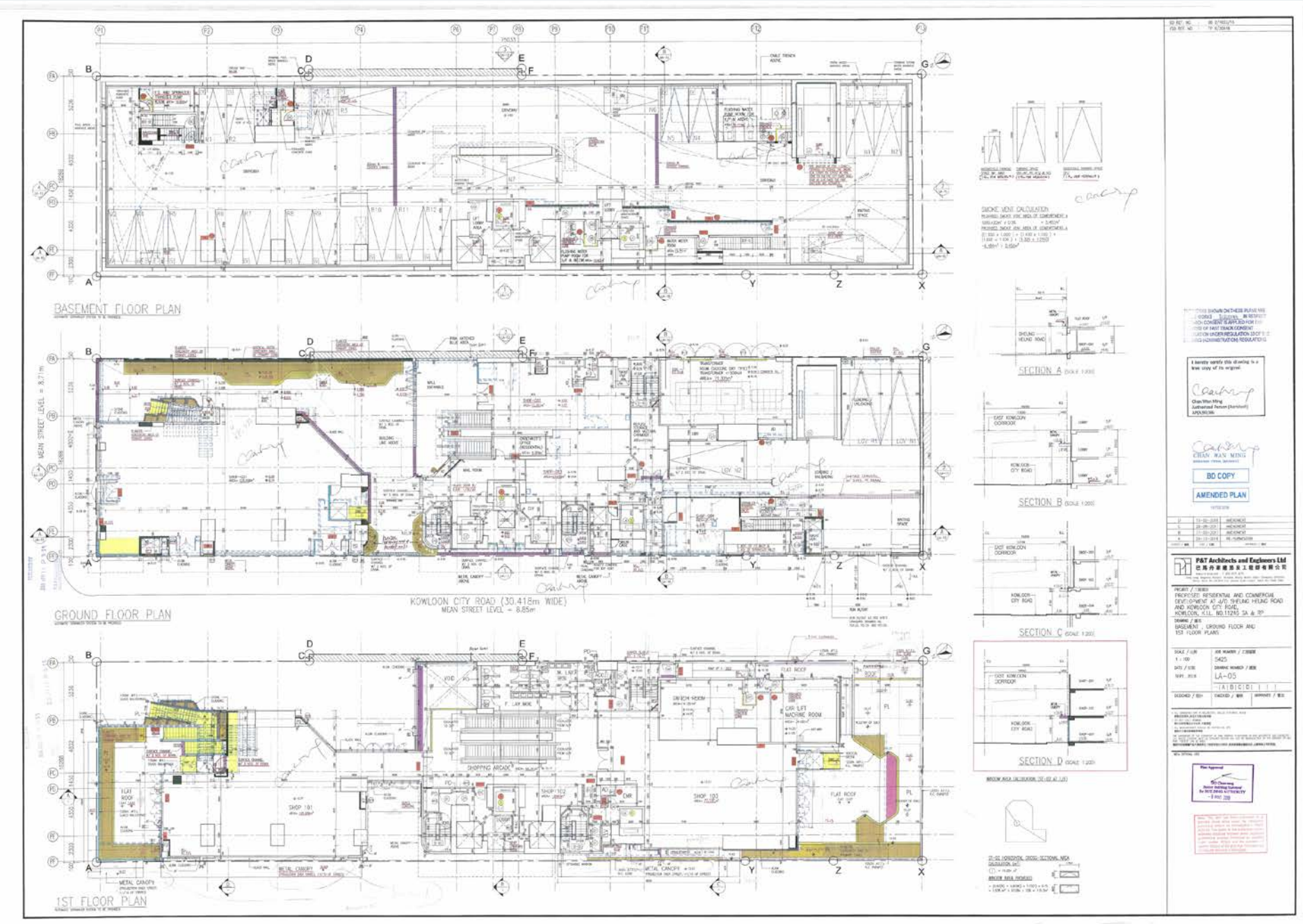

Most updated 2D drawings
Ensure all users communicate with same and latest
Information to enhance the work efficient and accuracy.



360 Site Photo

Construction Planning & Walkthrough Video

Walkthrough is the good way for fast track review the overall contents of the building design to help the project team to identify the conflict, make judgement and design change consideration

Construction Planning (Sheung Heung Road)

Walkthrough Video (Kings Road)

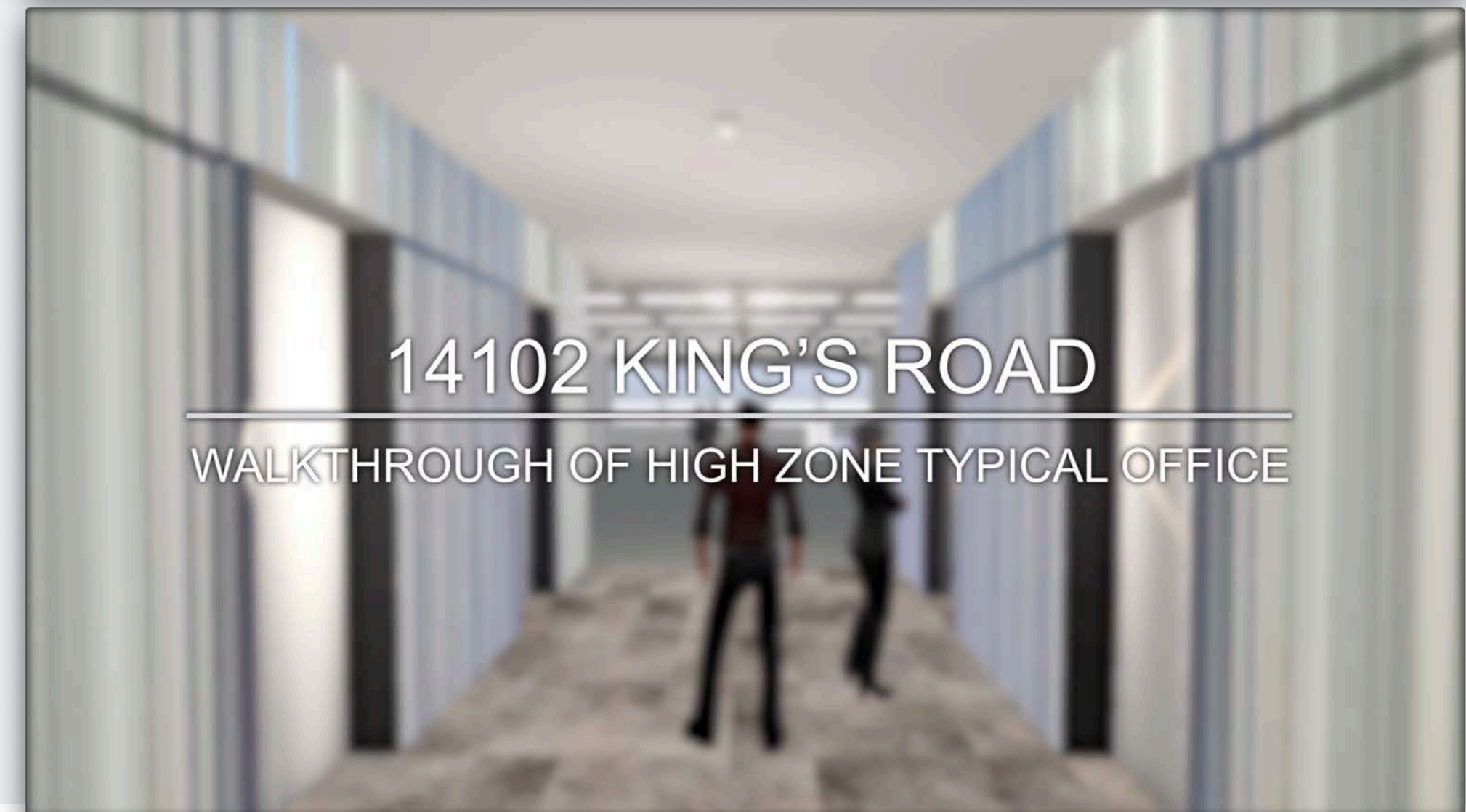

Virtual Visual Mock-up (VVMU) is used for preview and pre-rectification original design before actual construction to minimise the design change and cost implication.



Design Information - GIA

Geometry Information Access (GIA) is a web-based interface in which users can get access to information of the building/infrastructure with a few strokes.

Currently users can get access to information such as the views of the building (overview, floor views and section views) and numeric information such as quantity take offs and measurements.

With its viewport markups and live review functions, GIA provides users a platform to facilitate collaboration meetings and reviews.

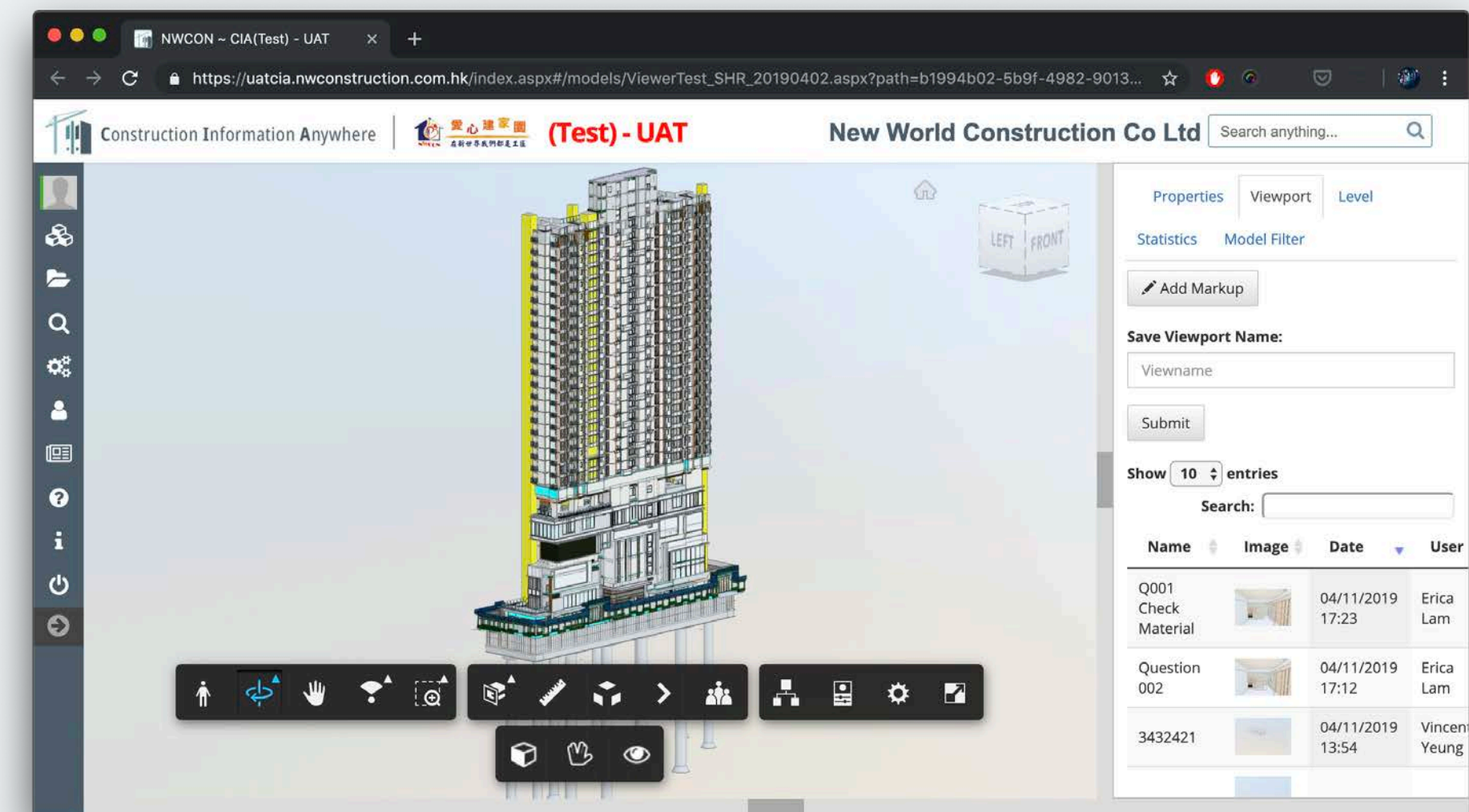

Thanks!

